

SEM_2_2018



OPPORTUNISTIC



URBANISM

NETHERLANDS TRAVELLING STUDIO
ROTTERDAM AMSTERDAM THE HAGUE

MASTERS ARCHITECTURE, LANDSCAPE + URBAN DESIGN STUDIO
FULL SEMESTER STUDIO WITH TRAVEL FROM AUG_27 >> SEP 7

FOR MORE INFORMATION CONTACT [OPPORTUNISTIC.URBANISM @ GMAIL.COM](mailto:OPPORTUNISTIC.URBANISM@GMAIL.COM)

msd
Melbourne
School of Design

FACULTY OF
ARCHITECTURE,
BUILDING AND
PLANNING
www.msd.unimelb.edu.au



TU Delft Delft
University of
Technology



PREFACE

This international studio exposes students to the distinctive 'Dutch approach' to architecture and urbanism. In particular the studio focuses on experiments in urbanism which emerged in the Netherlands following the Global Financial Crisis in 2008, particularly within urban renewal precincts.

Based in Rotterdam, but visiting Amsterdam, Delft and The Hague, the studio responds to a live research brief from Rotterdam-based think-tank Deltametropolis Association. The 2018 research project focuses on De Stad Van De Toekomst or 'City of the Future' project. The exercise is to explore within a case study 1km x 1km urban block how Dutch cities can rapidly transition their energy, waste and other urban systems as a showcase to meet the challenges of the future.

Our job is to test these ideas in experimental neighbourhood designs which learn from and improve upon exemplars across Northern Europe as well as some local examples such as Nightingale and Assemble.

The studio is integrated within Deltametrapool's broader research agenda to promote the attractiveness of the South Holland 'Delta City' to local and foreign workers through the power of a well connected network of compact cities, which is comparable in size and population to Metropolitan Melbourne.

During the two weeks in the Netherlands, students will participate in studio visits, workshops and field trips to exemplary projects by bike, rail and water bus. As this studio is open to both Master of Architecture, Landscape Architecture and Master of Urban Design students, participants may choose to place more emphasis on the city regional and precinct level strategies, or the design of individual dwellings or building typologies. All projects must however incorporate a housing component.

The studio outcomes are intended to contribute to the MSD Melbourne Housing Expo, promoting new ways of thinking about housing and living environments.

STUDIO LEADERS

Katherine Sundermann - MGS Architects
Andy Fergus - City Of Melbourne

CORE COLLABORATORS

Tom Alves - Melbourne School of Design
Anastasia Chranioti - Deltametropolis Association
Paul Gerretsen - Deltametropolis Association
Luis De Carvalho Filho - TU Delft
Alex Wandl - TU Delft
Gemente Rotterdam

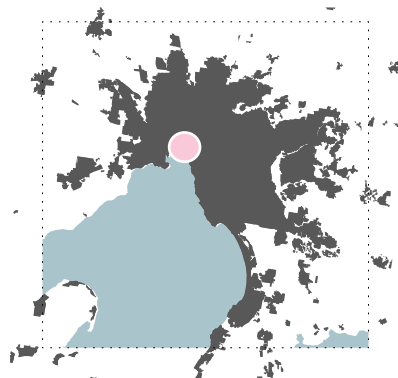

MELBOURNE 100 X 100 KM



SOUTH HOLLAND 100 X 100 KM



STUDIO BRIEF AND OUTCOMES

STUDIO BRIEF

The studio has been designed to respond to the brief from Deltametropolis Association to explore alternative development scenarios for four strategic 1 x 1 km sites within Rotterdam and The Hague. These centrally located precincts are all under pressure for development in the coming years, and we will be looking to speculate on the function, form and feel of these future neighbourhoods with an aim to influence real world outcomes.

The overarching themes for the studio are as follows:

- Explore exemplar community led renewal projects in Australia and Northern Europe.
- Explore the 'Dutch approach' to design, encompassing the role of water, history of urban development practices, and good and not so good examples from the late 20th, early 21st century.
- Explore the principles of 'circular economy' and advanced mobility, energy, waste and water systems.
- Engage with the key social and environmental challenges of the 21st century within the Dutch context.
- Speculate on potential neighbourhood development within the four study sites.
- Explore a flexible approach to framework plans for 'slow growth' as well as some of the lessons of self-build or community led development in the post-GFC period.
- Explore alternate approaches to housing at a neighbourhood scale, and supporting community infrastructure

The eventual projects will comprise design proposals at a range of scales (Metropolitan, Neighbourhood, Building and Experiential) which navigate between the brief of Deltametropolis Association, the above themes, and self directed individual agendas and briefs to be developed in Weeks 1-5.

OUTCOMES

The studio is split into three main components as follows:

BACKGROUND RESEARCH

(Weeks 1-5)

A series of exercises (both group work and individual work) acting as an introduction to the Netherlands, the project sites and project brief, compiled into a studio publication. In class workshops will supplement these exercises.

Exercises include:

- Exercise 1 - Introducing your personal agenda and 100 word written statement.
- Exercise 2 – Reviewing literature related to studio themes.
- Exercise 3 – Fitzroy Neighbourhood Visit and sketch studies of the city at eye level.
- Exercise 4 - Analysing and comparing exemplar community led renewal precincts
- Exercise 5 - Revised agenda and thesis statement.
- Exercise 6 - Analysing and comparing exemplar community led renewal precincts continued
- Studio publication - Bringing all the research completed together into a compact, well designed publication.

TRAVEL WEEKS

(Weeks 6-7)

An intensive two weeks of project visits, studio visits, workshops, and presentations. A mid-semester presentation will be held towards the end of the two weeks, with students presenting their first thoughts on their site specific concepts for high quality living environments within their selected 1 x 1km area.

FINAL PROJECT DEVELOPMENT

(Weeks 8-12)

Focused group and one on one sessions leading up to the intercrit and final presentations. On return from the Netherlands, students will prepare a detailed schedule for work in the final weeks. No workshops or exercises are scheduled to allow for maximum time in class to develop compelling final projects. An exhibition will follow the end of semester.

ASSESSMENT

Assessment is as follows:

- Exercises 1-6, Weeks 1-5 (10%)
- Mid-semester presentation, Week 7 (10%)
- Interim crit, Week 9 (10%)
- Final design presentation, Week 14 (10%) and folio (60%)

Monday, August 27 - Amsterdam

Exemplary architecture bike tour	9.00 9.15-13:00 13:00-14:00 14:00-17:00 17:00- 18:00 18:00-	Meet at Amsterdam Centraal station with bikes Bike tour Amsterdam West-South Lunch at Sarpharti Park, De Pijp Bike tour Amsterdam East-North De Ceugel tour with Space&Matter Free time
-------------------------------------	--	--

Tuesday, August 28 - Amsterdam / Rotterdam

Failed Architecture workshop	8.30 9.00 9.15-13:00 13:00-14:00 14:00-15:00 15:00-19:00 19:00	Check baggage into locker at train station Meet at NDSM Ferry terminal Tour of Amsterdam Noord Lunch in Buiksloterham Train to Rotterdam Check into accommodation in Rotterdam/free time Group dinner in Rotterdam
---------------------------------	--	--

Wednesday, August 29 - Rotterdam / The Hague

Dordrecht site visit	9.00-10:00 10:00-10:30 10:30-13:00 13:00-18:00 18:00-	Meet at Deltametropol offices, discuss sites Train to The Hague Walk around city centre and lunch Visit 1x sites in The Hague Group dinner in The Hague / free time
----------------------	---	---

Thursday, August 30 - Rotterdam

Rotterdam site visit	9.00 9.00-10:00 11:00-13:00 13:00-17:00 17:00-18:00 18:00-	Meet at City of Rotterdam with bikes Talk at City of Rotterdam Tour of Rotterdam by bike and lunch Visit 3x sites in Rotterdam Studio Visit Free time
----------------------	---	--

Friday, August 31 - Delft

TU Delft workshops	9.00 9.00-9:45 10:00-12:00 12:00-13:00 13:00-15:00 15:00-17:00 17:00-18:00 18:00	Meet at Rotterdam Centraal station Travel to TU Delft TU Delft Workshop #1 Lunch at TU Delft TU Delft Workshop #2 Free time in Delft Visit to Spoorzone Ground dinner in Delft
--------------------	---	---

Saturday, September 1 - Rotterdam or The Hague

Site analysis day	10:00-11:00 11:00-17:00 17:00-	Studio briefing (at cafe in Rotterdam) Site visit/analysis in groups of four Free time
-------------------	--------------------------------------	--

Sunday, September 2 - Anywhere you wish!

Free time

DRAFT - IN DEVELOPMENT

Monday, September 3 - Rotterdam

Community-led Development Workshop	9.45 10:00-12:00 12:00-13:00 13:00-15:00 15:00-18:00 18:00-	Meet at Wijkpaleis, Rotterdam Community-led development workshop Lunch in Middeland Project Visit with Vincent Taapken / Marieke Hillen Group project work Free time
---------------------------------------	--	---

Tuesday, September 4 - Rotterdam

Studio Working Day	10:00 10:00-12:00 12:00-13:00 13:00-17:00 17:00-18:30 18:30-	Meet at Deltametrapool Office Present group site analysis Lunch in Central Rotterdam Bookable 1 on 1 design development sessions ZUS Office visit at Schieblock Free time
--------------------	---	--

Wednesday, September 5 - Rotterdam

Studio Working Day	09:00-14:00 14:00-17:00 17:00-	Individual design development Individual draft presentations Free time
--------------------	--------------------------------------	--

Thursday, September 6 - Rotterdam

Studio Working Day	09:00-14:00 14:00-17:00 17:00-	Individual design development Individual draft presentations Free time
--------------------	--------------------------------------	--

Friday, September 7 - Rotterdam

Mid-semester presentation	09:00-14:00 14:00-17:00 17:00-19:00	Individual design development Bookable 1 on 1 design development sessions Mid-semester presentations with Alan Pert and Netherlands Guests
---------------------------	---	---

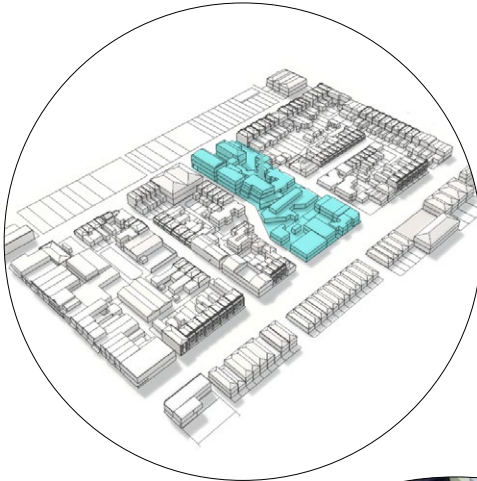
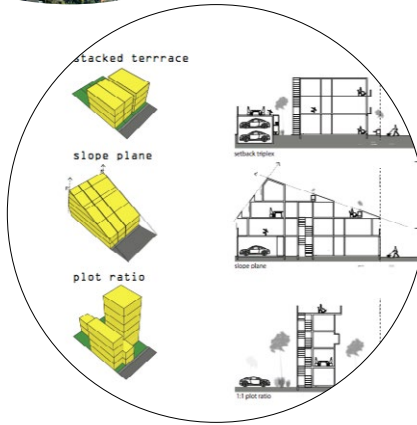

REFERENCES & LITERATURE

Metropolitan Competitiveness

- o LSE Cities (2011) The tale of two regions: comparison between the metropolitan areas of South East England and the Randstad in Holland. Pages 3-30
- o Monocle Liveable City and Quality of Life Surveys
<https://monocle.com/film/affairs/top-25-cities-2016/>
<https://monocle.com/film/affairs/most-liveable-city-2016-tokyo/>
<https://monocle.com/film/affairs/quality-of-life-survey-top-25-cities-2017/>

Creative Workers

- o Ted X Chiang Mai – Amari Charoenphan Co-Working can Change the World
<https://www.youtube.com/watch?v=W0RSc9mtZp4> Ted X Chiang Mai
- o Woodland, M. (2017) What happens when the Prairie Dogs Abandon their Cubicles?
- o Failed Architecture Colonising the Street – How Green points Retail Newcomers Market Authenticity <https://www.failedarchitecture.com/colonising-the-street-how-greenpoints-retail-newcomers-market-authenticity/>

Demographic Trends

- o MADA (2015) Age Friendly Cities and Neighbourhoods. An ARC Linkage Project
- o Widdicombe, L. (2016). Happy Together – The Rise of the Co Living Start-up
<http://www.newyorker.com/magazine/2016/05/16/the-rise-of-the-co-living-startup>

Control vs Flexibility

- o Lehnerer, A. (2009). Grand urban rules. 010 Publishers. (Chapter 1 Rules as Tools, A token of affection)
- o Hodyl, L. (2015). To investigate Planning Policies that deliver positive Social Outcomes in hyper-dense, high-rise residential environments
- o Urban Urban Design (2010). The Spontaneous City. BIS Publishers. (Manifesto for a spontaneous city)

User Led Development

- o Parvin, A (2015) An Open Manifesto for Housing <https://medium.com/@AlastairParvin/an-open-manifesto-for-housing-a56cf4eed2a1>
- o Parvin, A (2016) A Right to Regenerate <https://medium.com/@AlastairParvin/a-right-to-regenerate-f93969d84c8d>
- o Neue Hamburger Terrassen LAN Architecture - <https://vimeo.com/105240214>
Ritterstrasse 50, Heide and Von Beckerath Architecture - R50 Berlin video <https://vimeo.com/87466748>

Living with Water

- o Hooimeijer, F. (2014). The Making of Polder Cities. A Fine Dutch Tradition. Jap Sam Books. (Chapter 1 & 2)
- o MUST, Witteveen Bos. (2013) Water Resistant Westpoort. Pilot Study of Critical Functions in the Port of Amsterdam Gemeente Amsterdam (2013) Amsterdam Rainproof www.rainproof.nl

Urban experience

- o Gehl, J (1977) The Interface between Public and Private Territories in Residential Areas. (Initial Chapter)
- o Stipo - The City at Eye Level Short Film Series

